

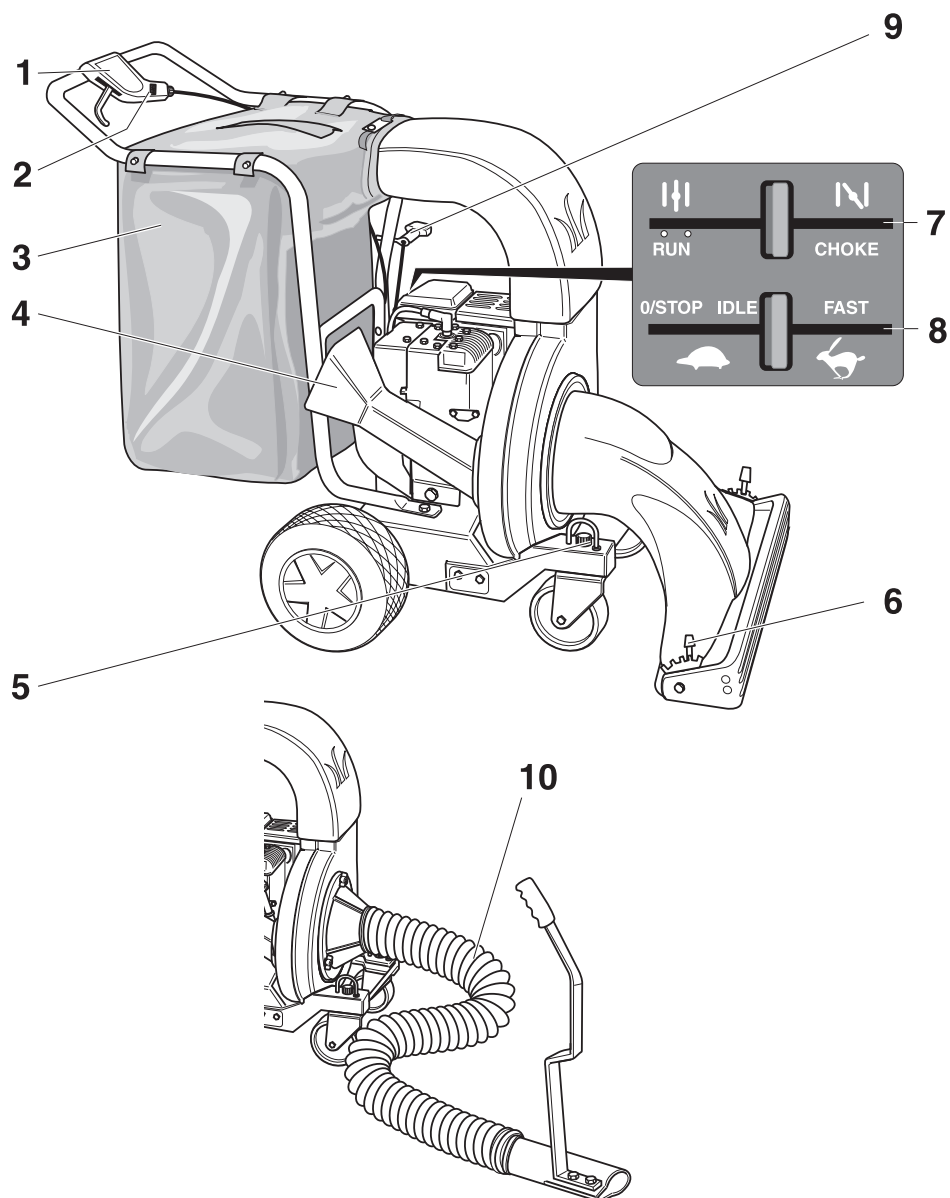

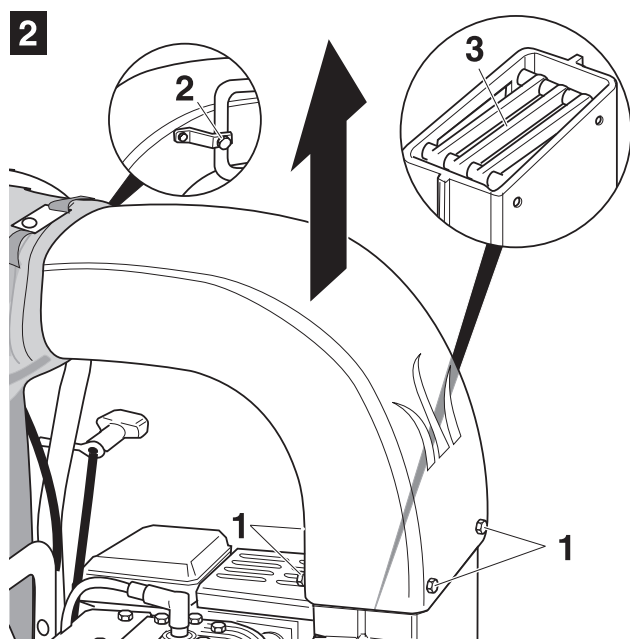

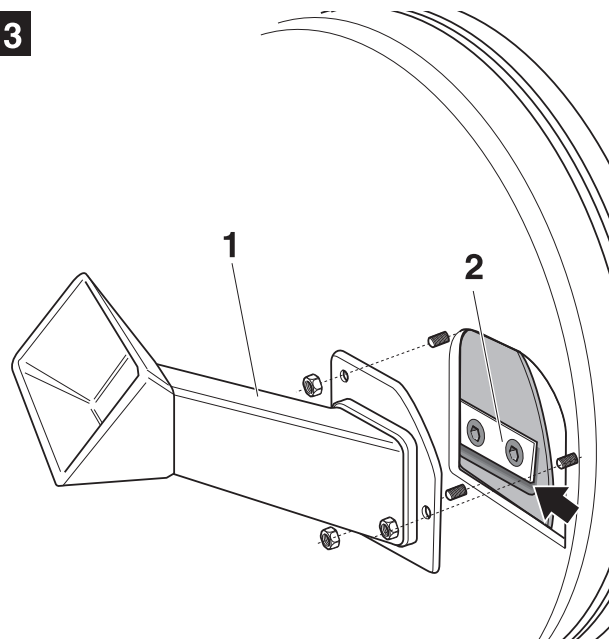





J 08
FORM NO. 770-1039B



1**2****3**

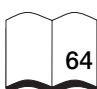
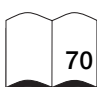

English (Translation of original operating instructions)	→	 4
Français (Traduction de la notice d'instructions d'origine)	→	 10
Deutsch (Originalbetriebsanleitung)	→	 17
Nederlands (Vertaling van de originele gebruiksaanwijzing)	→	 23
Italiano Traduzione delle istruzioni per l'uso originali)	→	 29
Español (Traducción de las instrucciones de funcionamiento originales)	→	 35
Svenska (Översättning av originalbruksanvisningen)	→	 41
Dansk (Oversættelse af den originale driftsvejledning)	→	 46
Norsk (Oversettelse av den originale driftsanvisningen)	→	 52
Suomi (Käännös alkuperäisestä käyttöohjekirjasta)	→	 58
Português (Tradução das Instruções de serviço originais)	→	 64
Ελληνικά (Μετάφραση των αυθεντικών οδηγιών χειρισμού)	→	 70

Contents

For your safety	4
Assembly	6
Overview	6
Operating procedure	6
Transporting the machine	7
Cleaning the machine	7
Maintenance	7
Long-term storage	8
Warranty	8
Information about the engine	8
Troubleshooting	8

Information on rating plate

These details are very important as they will be needed for identifying your machine when ordering replacement parts and will also be required by Customer Service. The rating plate can be found next to the engine.

Copy all details from the rating plate on the machine into the box below.

This and other information about the unit can be found on the separate CE Declaration of Conformity which is a component of this operating manual.

Illustrations

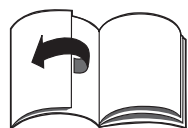

Fold out the illustrated pages at the start of the operating manual. The graphical representation may differ in detail from the unit which you purchased.

For your safety

Using the machine for its intended purpose

This appliance is designed for use in the house and garden

- vacuuming leaves and garbage

- shredding twigs and small branches
- and should be used according to the procedures and safety information described in the operating instructions.

Any other use is not as intended.

The user is liable for all damage caused to third parties and their property.

Furthermore, the manufacturer will not be liable for any damage that arises as a result of unauthorised modifications to the machine.

General safety information

Please read the operating instructions carefully before using the machine for the first time. Observe all safety information while operating the machine.

Make sure that

- you are familiar with all safety information,
- all users of the machine have been made aware of and understand the safety information.

Children

Remain alert as to the presence of children in the vicinity of the machine in order to avoid a tragic accident. Motorised equipment is often of great attraction to children. Never assume that children will remain in the same place as when you last saw them.

Do not allow children to operate or otherwise handle this machine.

Before all work on this appliance

If the appliance has an engine, always turn off the engine before doing any working on it (e.g. repair work and adjustments) and before transporting it (e.g. lifting or carrying) in order to avoid injury

- switch OFF the engine,
- wait until all moving parts have come to a complete stop and the engine has cooled down,
- remove the spark plug connector on the engine in order to prevent the engine from accidentally being started,

- observe the additional safety information in the operating instructions for the engine.

Filling the fuel tank

Take care when handling petrol. Petrol is highly flammable and the vapours that it gives off are explosive.

Store petrol

- in properly approved containers only,
- in a room to which children have no access,
- in a room that is protected from heat or sparks.

Do not refill the fuel tank in an enclosed space or while the engine is running or is hot.

Before you start the engine, wipe off all traces of fuel and wait until the petrol vapours have dispersed.

Unless you are actually refuelling, keep the tank sealed tightly with the cap. Stay away from naked flames when filling the tank and do not smoke or do anything that could generate sparks.

Replace the fuel tank and its cap if they become damaged.

While the machine is in use

Make sure that no persons, especially children, or animals enter the working radius of the machine.

Do not leave the machine unattended with the engine running.

Guide the machine forwards at walking pace.

When working with the machine, always wear

- protective goggles,
- sturdy shoes,
- close-fitting clothing which cannot get caught up in the machine.

Wear gloves that are tight-fitting and have no parts, in particular laces, hanging down.

Wear a cap to prevent loose hair from become caught up in the machine.

If necessary wear ear protectors as well.

In order to avoid a fire hazard, keep the engine and exhaust system free from grass, leaves or spilt fuel and oil. The ground which is to be covered by the machine should be cleared of any stones, toys, wire, etc. which could be picked up by the blower or

shredder mechanism and catapulted away.

Items that you overlook could be unintentionally ejected at high speed in any direction, which could result in injury to yourself or anyone standing nearby.

Do not run the engine in an enclosed space; danger of asphyxiation caused by poisonous gases!

Keep your hands, feet, face and clothing away from the shredder funnel and all rotating parts on the machine.

Do not use the machine to pick up materials that could cause a blockage inside the blower, such as pieces of wood or metal, bottles, etc.

Operate the machine during daylight hours only or when there is adequate artificial lighting.

Do not use the machine unless the suction nozzle and collecting bag have been attached properly.

The zip fastener on the rear of the bag must remain closed while the machine is in operation, in order to prevent the contents from being ejected at high speed.

Do not empty the bag while the engine is still running.

Always turn the engine off when you are not actually using the machine.

Splintering wood can sometimes be quite dangerous. If you have someone helping you to feed wood into the machine, make sure this person stands well away from the machine when it is started up.

The more people that stand around the machine, the greater the risk of an accident occurring.

Do not operate the machine on slippery, wet, loose or frozen ground. A solid footing is essential in order to avoid accidents.

Only operate the machine on level ground and not on a slope.

There is a risk of injury if the machine tips over or the operator slips.

After the machine has been switched off

Fire hazard – Allow the engine to cool down before you park it in an enclosed space.

During transport

The engine must be switched off before the machine is transported to a new location.

Symbols on the machine

On the appliance you will find various symbols on adhesive labels. They have the following specific meanings:

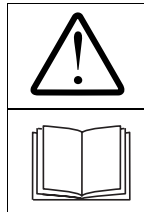

Warning! Please read the operating instructions before putting appliance into operation!



Keep third parties away from the danger area!



Never put your hands and/or feet in the vicinity of rotating parts.



Attention! Sharp cutting tools. Keep hands and feet away.



Injury hazard – Before commencing any work on the machine

- switch off the engine
- wait until all moving parts have come to a standstill
- pull off the connecting cap on the spark plug so that it is impossible to start the engine unintentionally.

Always wear eye and ear protection!

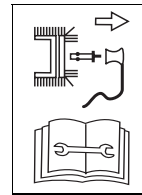

Before doing any work, e.g. adjusting, cleaning, checking the machine etc., switch off the machine and disconnect the spark-plug terminal!

Always keep these symbols on the appliance in a legible state.

Symbols used in the operating instructions

The following symbols are used in these operating instructions:

Danger!

Used to draw your attention to sources of potential danger which are associated with the activity being described and represent a risk for persons.

Caution!

Used to draw your attention to sources of potential danger which are associated with the activity being described and could result in damage to property.

Note

Indicates important information and application tips.

Safety devices

Safety devices are provided for your protection and should be maintained in proper working order at all times. You must not modify the safety devices in any way or attempt to bypass their function.

The safety devices are:

Clutch lever

When you release the clutch lever, drive to the wheels is cut off immediately.

Safety switch

The safety switch is actuated whenever the suction nozzle or hand vacuum unit is attached. It is not possible to operate the machine without either the suction nozzle or the hand vacuum unit in place.

Collecting bag

The collecting bag must be closed while the machine is in operation.

Assembly

At the end of the operating instructions you will find a series of drawings that illustrate how to assemble the parts of the machine.



Disposal instructions

Dispose of packaging remnants, old units, etc., in accordance with local regulations.

Overview

Figure 1

Clutch lever for drive to the wheels (1)

To travel forwards:

Pull and hold the clutch lever

To stop the machine:

Release the clutch lever

Clutch adjustment (2)

Set the point at which the clutch engages by turning the knurled wheel.

Collecting bag (3)

Shredded material is ejected into the collecting bag. To empty the bag, unzip the fastener on the back.

Shredder chute (4)

For shredding twigs and thin branches.

Locking the front wheels (5)

Locking the wheels for travelling straight ahead:

Turn the wheels to the front and

insert the clamp into the large hole.

Wheels move in any direction:

Insert the clamp into the small hole.

Suction nozzle with height-adjustment lever (6)

For adjusting the height of the suction nozzle above the ground.

Choke (7)

Starting a cold engine:

Lever set to "CHOKE"

Starting a hot engine:

Lever set to "RUN"

Throttle lever (8)

Fast engine speed:

Throttle set to "Rabbit"

Slow engine speed:

Throttle set to "Tortoise"

To stop engine:

Throttle to "0/STOP".

Pull-starter (9)

For starting the engine by hand.

Hand vacuum unit (10) (optional)

For vacuuming areas that are difficult to reach such as between or in flower beds, under low bushes, etc.

Operating procedure

Also follow the instructions in the engine handbook.



Caution

For reasons of transportation the unit is delivered without engine oil.

Therefore, you must fill the engine with oil before putting into operation for the first time. Please see engine manual.

Before you start the engine

- Open fuel cock (if one is available – please see engine operating instructions).
- Close the zip fastener on the collecting bag.
- Check that the collecting bag is securely attached to the outlet chute.
- Check that the suction nozzle is firmly attached.
- Check the engine oil level (see engine operating instructions).
- Check that there is sufficient fuel in the tank, and top up if necessary (gasoline, unleaded; see engine operating instructions).

Figure 1

Starting the engine

- Set the choke (7).
If engine is cold, set lever to "CHOKE".
If engine is hot, set lever (8) to "RUN".
- Set the throttle lever to "Rabbit".
- Pull the starter cord (9) slowly until you can feel a build-up of resistance and then pull it all the way out in one firm, rapid movement. Do not leave go of the cord so that it recoils too quickly. Allow the cord to rewind slowly.
- When the engine is running, reduce the engine speed by adjusting the throttle lever (8) until the engine runs smoothly.
- Set the choke lever (7) to "RUN".

Stopping the engine

Before you stop the engine, first of all allow all the pieces of wood in the shredder chute to become properly shredded.

- Release the clutch lever (1)
- Set the throttle lever (8) to "0/STOP". The suction unit and shredder continue running for a few seconds after the engine has been switched off.
- Pull the cap off the spark plug in order to make it impossible for the engine to be started unintentionally.

Vacuuming

If you are going to be vacuuming across uneven ground or on ground that has a slight slope, to make the machine easier to handle, turn the wheels so that they are pointing straight forward and then lock them in this position.

Always pull the clutch lever slowly.

The same applies when you release the lever.

- Set the throttle lever (8) to "Rabbit".
- Pull the clutch lever (1).

The machine moves forward and vacuums the ground across which it is travelling.

Working with the hand vacuum unit (optional accessory):

For vacuuming areas that are difficult to reach such as between or in flower beds, under low bushes, etc.

- Switch off the engine.
- Replace the suction nozzle with the hand vacuum unit.
- Guide the hand vacuum unit by the handle.

Shredding

Twigs and small branches up to a maximum of 5 cm in diameter can be fed into the shredding mechanism via the shredder chute. Do not shred hard wood or building timber (with nails or screws).

- Park the machine on a level surface and secure it against rolling away.
- Prepare the items to be shredded so that they can easily be fed into the shredder chute.
- Start the engine and set the throttle (8) to "Rabbit".
- Feed the wood into the shredder chute.

Emptying the collecting bag

- Switch off the engine and wait until all moving parts have come to a standstill.
- Open the zip fastener and empty the bag (3).

After finishing work

- Stopping the engine.
- Wait until all moving parts have come to a complete stop and the engine has cooled down,
- Close fuel cock (if available – please see engine manual).
- Disconnect the spark plug terminal on the engine.

Transporting the machine



Caution!

Environmental hazard due to spilt fuel

Do not tilt the machine to the side during transport.

When transporting the machine on or inside a vehicle, make sure it is held firmly in place and cannot slide around.

- Lock the front wheels.
- Secure the machine so that it cannot slide around.

Cleaning the machine

Whenever possible, clean the machine and the collecting bag immediately after they have been used.

Cleaning the collecting bag

- Switch off the engine and empty the collecting bag.
- Clean the bag with a powerful jet of water from a garden hose.
- Allow the bag to dry out thoroughly before you use it again.

Cleaning the machine

- Use a brush to remove all dirt and leaves from the machine, especially around the engine and the cooling ribs.

Maintenance

Maintenance schedule

Maintenance tasks	Daily or after every 8 h	Weekly or after every 25 h	Monthly or after every 40 h	1½-yearly or after every 100 h	Annually or after every 500 h	As necessary
Check oil level, and replenish if required	●					
Check that all threaded connections are tight, and make corrections if necessary	●					
Clean air filter	See engine operating instructions.					
Inspect air filter, and replace if necessary	See engine operating instructions.					
Check all safety device *			●			
Change engine oil	First oil change after 5 h – For subsequent intervals see engine manual.					
Lubricate all moving parts			●			
Replace spark plug *	See engine operating instructions.					
Check tyre pressure, and make corrections if required – see Technical Data			●			
Check condition of exhaust system and make sure there are no holes; replace if necessary *					●	
Check clutch setting						●
Check carburettor setting *						●
Clean flail cover grille						●
Sharpen or replace shredder blades *	●			● ¹⁾		●

* These tasks should only be performed in an authorised service centre.

Maintenance tasks

Have the machine inspected and serviced in an authorised service centre once per season.

Danger

Risk of injury through the engine being unintentionally started.

To protect against injury before all work on the appliance

- switch OFF the engine,
- wait until all moving parts have come to a complete stop and the engine has cooled down,
- remove the spark plug connector on the engine in order to prevent the engine from accidentally being started,
- which takes into account additional safety information in the engine manual.

Caution

Observe the servicing instructions in the engine manual. At the end of the grass-cutting season, have the lawn scarifier checked and serviced in a specialist workshop.

Lubricating moving parts

Apply a few drops of machine oil to the:

- wheel bearings (remove covers on rear wheels).
- mechanism for adjusting height of suction nozzle.

Checking engine oil level

See engine operating instructions.

Changing the engine oil

See engine operating instructions.

Caution!

Environmental hazard caused by engine oil

When you change the engine oil, take the old oil to a designated waste oil collection point or to a specialist disposal company.

Cleaning the air filter

See engine operating instructions.

Cleaning the flail cover grille and blower housing

Figure 2

It will not be possible for the shredded material to be ejected if the flail cover grille becomes blocked.

- Pull the cap off the spark plug.
- Undo the collecting bag from the outlet chute and detach it from the handlebars.
- Undo the self-tapping screws (1) in the outlet chute.
- Undo the hexagon-head screw (2) and nut on the outlet chute.
- Lift off and clean the outlet chute.
- Clean the flail cover grille (3) on the shredder.
- Clean the blower and shredder wheel above the suction nozzle opening.

Re-assemble all parts in reverse order.

Checking the shredder blades

Figure 3

- Pull the cap off the spark plug.
- Remove the shredder chute (1).
- Inspect the shredder blades (2).
If the shredder blades are blunt, take them to a specialist workshop to be sharpened or replaced.

Long-term storage

For example, at the end of the gardening season or if you are not going to use the machine for a period longer than a month:

- Clean the machine and the collecting bag.
- Apply oil to all lubricate points.
- Wipe over all parts with an oily rag (resin-free oil) to protect them from rust or spray them with machine oil.
- Follow procedure described in engine handbook for preparing engine for longer periods of storage.
- Park the machine in a sheltered location and secure it against rolling away.

Warranty

The applicable warranty conditions in different countries are issued by our subsidiary company or the importer of our products. During the warranty period, any malfunctions of the unit caused by a material or manufacturing defect will be repaired free of charge. In the event of a warranty claim, please contact your original dealer or the nearest authorised service centre.

Information about the engine

The engine manufacturer is liable for all problems related to the engine regarding performance, measuring performance, technical data, guarantee and service. You will find information in the separately enclosed owner's / operator's manual provided by the manufacturer.

Troubleshooting

Danger

Risk of injury through the engine being unintentionally started.

To protect against injury before all work on the appliance

- switch OFF the engine,
- wait until all moving parts have come to a complete stop and the engine has cooled down,
- remove the spark plug connector on the engine in order to prevent the engine from accidentally being started,
- take into account additional safety information in the engine manual.

If a fault occurs while you are operating the machine, it is quite often caused by something straightforward which you may well be able to identify and rectify yourself. If you are in any doubt, the nearest authorised service centre will be pleased to assist you further.

Problem	Possible cause(s)	Remedy
Engine will not start.	Fuel tank is empty or fuel is too old.	Fill tank with fresh, clean fuel.
	Ignition cable is not connected.	Connect ignition cable to spark plug.
	Defective spark plug.	Clean plug, set gap between electrodes or replace plug.
	If engine is cold: Choke lever not set to "CHOKE".	Set choke lever to "CHOKE".
Reduction in power Engine does not run smoothly.	Engine is running with choke lever set to "CHOKE".	Set choke lever to "RUN".
	Fuel old or dirty.	Replace with new fuel.
	Carburettor is misadjusted.	Arrange for carburettor to be set up in specialist workshop.
	Dirty air filter.	See engine operating instructions.
Excessive vibrations.	Loose parts or damaged blower wheel.	Switch off engine immediately and pull cap off spark plug. Tighten all nuts, screws and bolts. If vibrations still occur, have machine inspected in specialist workshop.
Machine does not eject shredded material.	Outlet chute is blocked or something is caught up in blower wheel or in suction nozzle/hand vacuum unit.	Switch off engine immediately and pull cap off spark plug. Remove cause of blockage or clean flail cover and blower housing inside machine. See section headed "Maintenance".
	Collecting bag is full.	Empty collecting bag.
Reduced travelling speed.	Clutch is slipping; Bowden cable has stretched.	Adjust point at which clutch engages by turning knurled wheel on clutch lever.
Speed at which shredded material is ejected has reduced considerably or shape of ejected material has changed.	Shredder blades are blunt.	Have shredder blades sharpened or replaced in specialist workshop.

